

# Artemide®

## Melampo

design  
A. Gardère

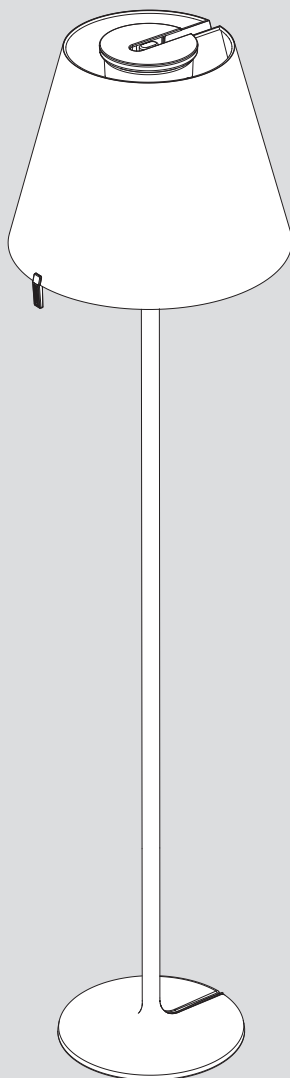

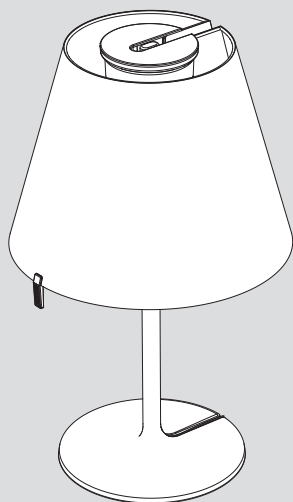

i

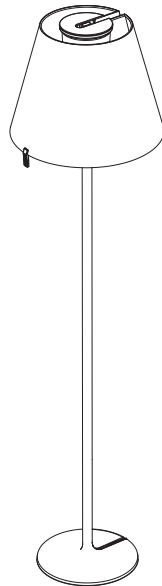
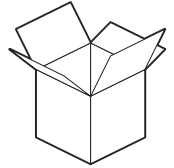
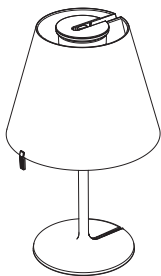
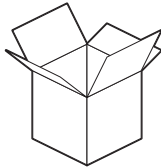
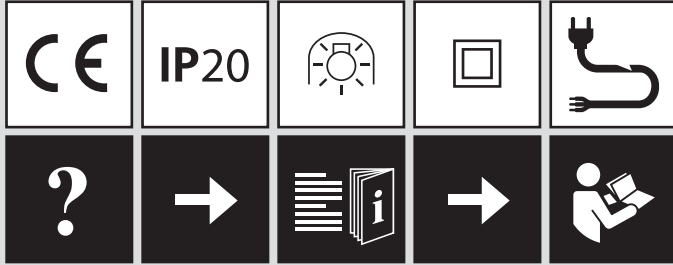

1

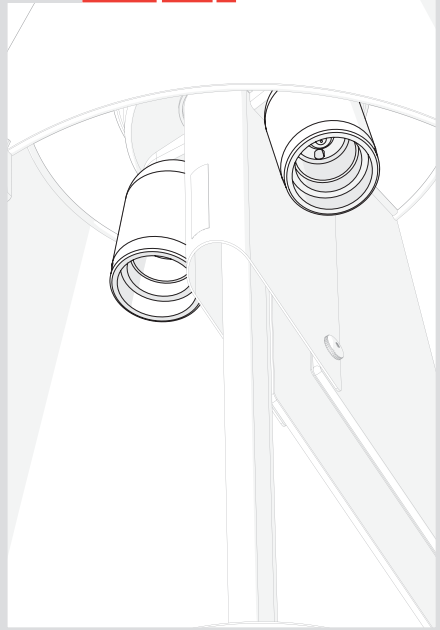

2

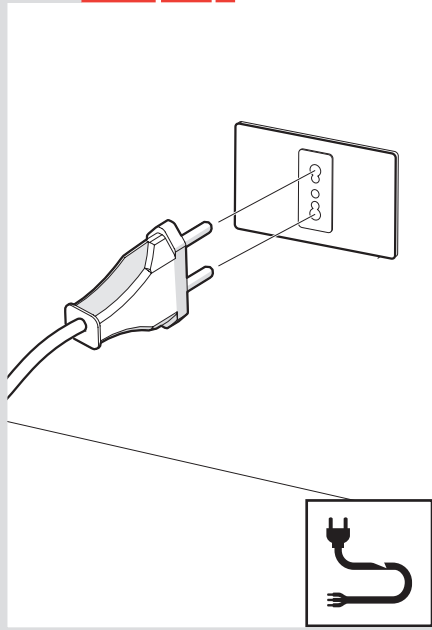

i

**2 x MAX 57W - E27**

Halo: HSGSA - 900 lm

LED: DRAA - 900 lm

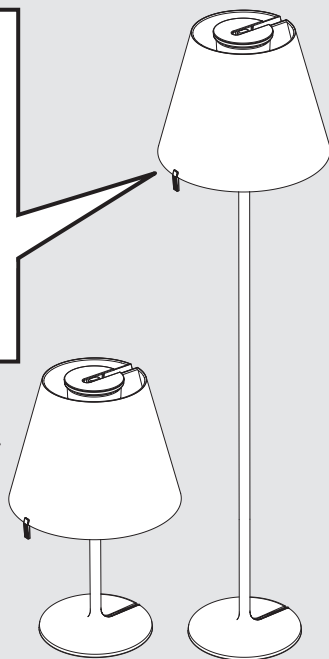



3a

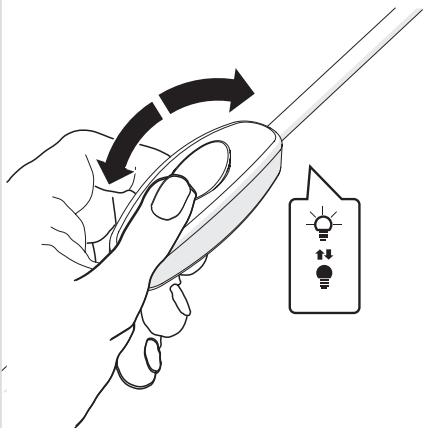

3b

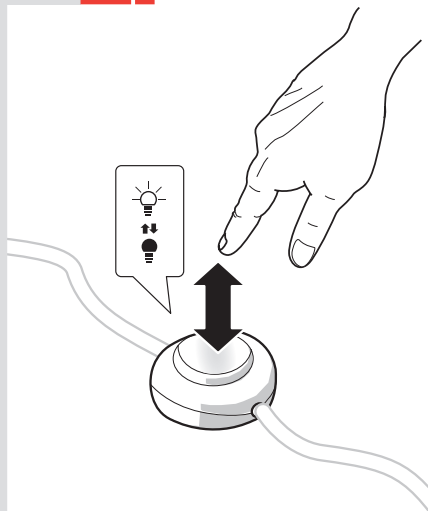

4

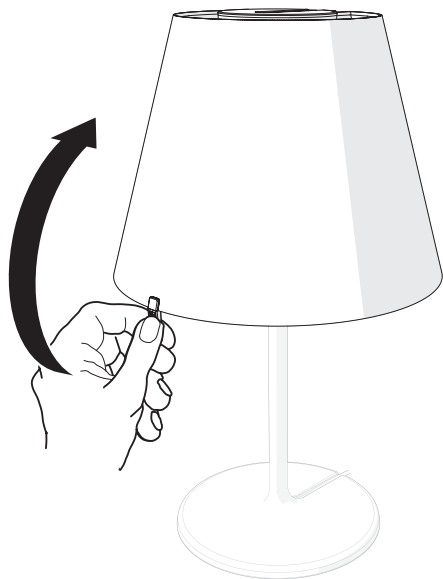

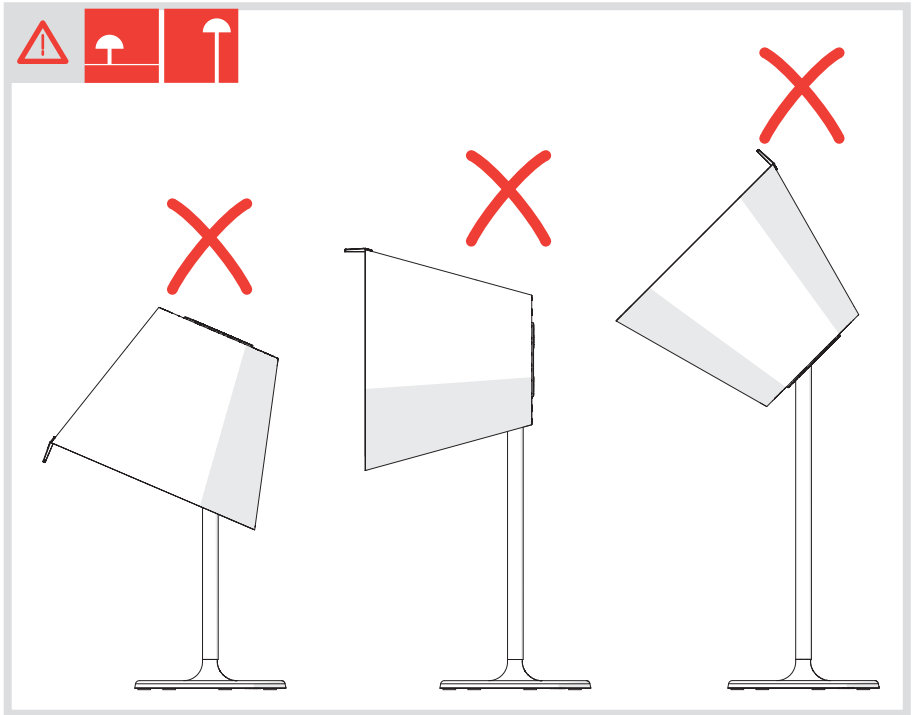
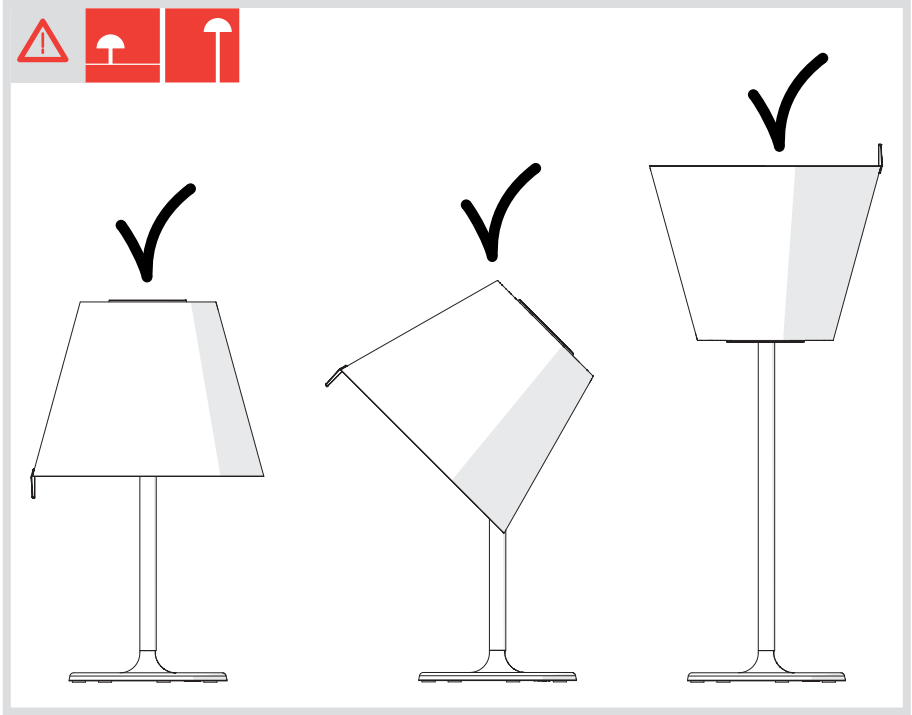

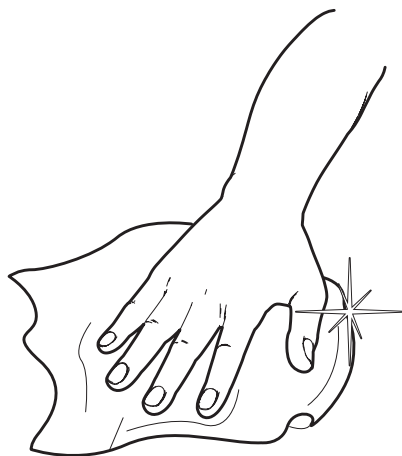
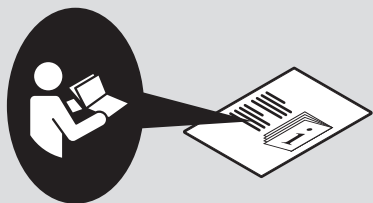



**Artemide®**



**Artemide**

via Bergamo, 18  
20010 Pregnana M.se (MI)  
ITALIA

tel. +39 02 935 181  
fax +39 02 935 90 254  
fax +39 02 935 90 496

[www.artemide.com](http://www.artemide.com)

VAT IT00846890150

cod. Y513000423