

# kreon

## technics

Name

Reference

Drive current

Module 120 LED low

KR907933-xxxx-xxx

700mA

## 1 dimensions

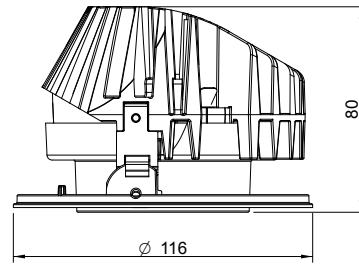

The luminaire must not under any circumstances be covered with heat insulating covers or similar materials.  
Cables must not touch the luminaire housing.  
The connection cable must be routed so that it does not touch the lamp when the luminaire is tilted.

## 2 installation

To install the plasterkit.  
See installation manual KR8170001755 or KR8070002005.

Please make sure that main voltage is disconnected before proceeding!

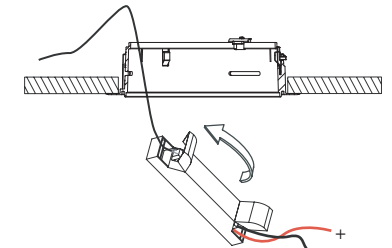

Install the correct gear with strain relief on the hollow ceiling.

## 3 installation

In case of LED important: always check the polarity!!  
+ = red wire - = black wire

Put the assembly in the plasterkit.

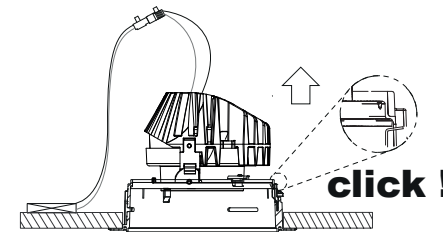
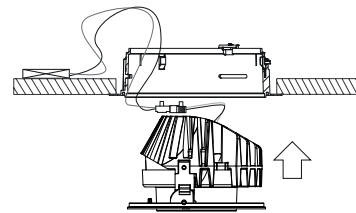
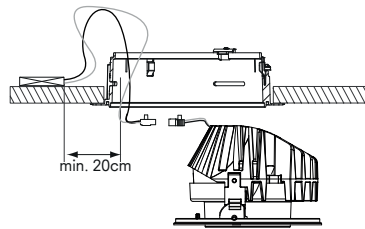

## 4 installation

Push filterholder to rotate inner part manually.

Turn inner part manual.

Optional:  
In case of adding a filter.

Add extra filter to the filterholder.

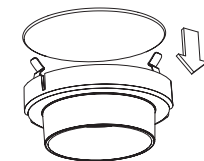
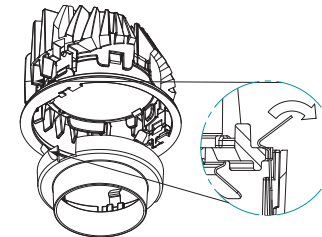
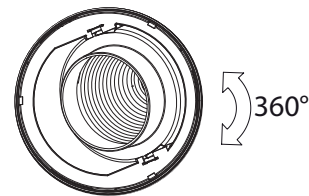
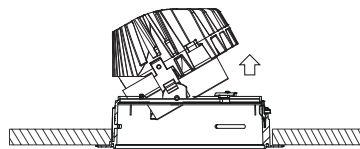

## technics

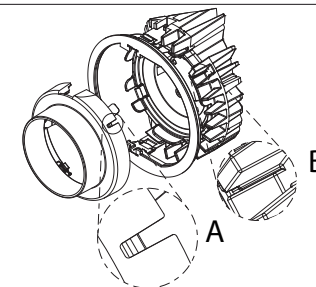
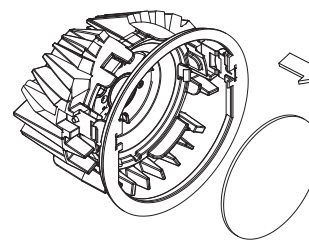
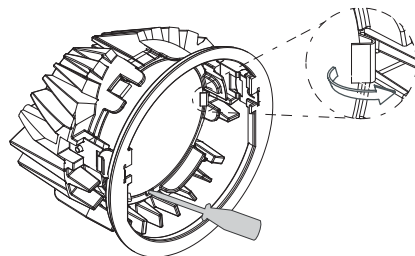
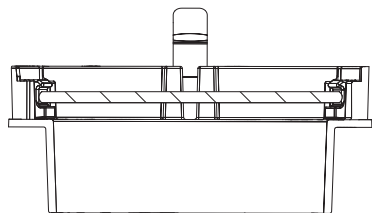

## 5 installation

Maximum capacity= one filter

In case of lens replacement bend the springs to remove the lens.

Remove the lens and add a new lens.

When adding the filterholder align A (cutout) with B (rib).

## 6 installation

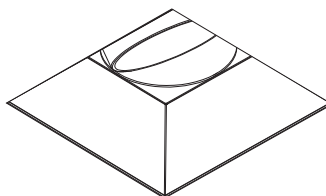
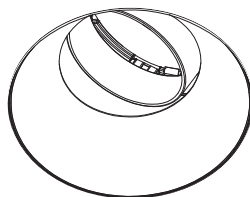

To install the louvre see manual KR8170001761 or KR8170001762.